

List of departments and services

Department	Wing	Level
A Antenatal clinic	Verulam	2
Audiology	Verulam	2
B Blood test clinic	Marnham	1
Bowel cancer screening	Verulam	3
C Cardiology outpatients	Verulam	2
Chapel	Jubilee	3
Chest clinic	Verulam	3
Children's outpatients (access via external side entrance directly off staff car park)	Verulam	1
Chronic obstructive pulmonary disease (COPD)	Verulam	3
CT (x-ray dept) parking available outside of the department entrance A	Main building	G
D Dermatology day unit / treatment centre	Marnham	upper
Diabetes clinic	Verulam	1
E Education, training and library (access via external side entrance)	Verulam	1
Endoscopy	Verulam	3
G GP out of hours service	Jubilee	3
Gynaecology outpatients	Verulam	2
H Haematology and Anticoagulation Clinic (Pathology)	Verulam	2
Hanover day unit (stroke prevention clinic)	Verulam	3
M Mortuary (external entrance)	Verulam	3
N Nuclear medicine	Jubilee	4
O Occupational therapy	Main building	1
Outpatients department (follow the yellow signs for outpatients)	Verulam	2
P Pharmacy dispensary	Jubilee	4
Radiology (X-ray, MRI, CT, Nuclear medicine, Ultrasound)	Main building	G
S Speech and language therapy (SaLT) next to UTC	Jubilee	3
T Thoracic medicine (lung function)	Verulam	3
The Real Good Coffee Co.	Verulam	2
U Ultrasound main / general (x-ray)	Main building	G
Urgent treatment centre (UTC)	Jubilee	3
W West Herts medical centre	Jubilee	1
X X-ray Parking available outside of the department entrance A	Main building	G

Hemel Hempstead Hospital

Department list and map

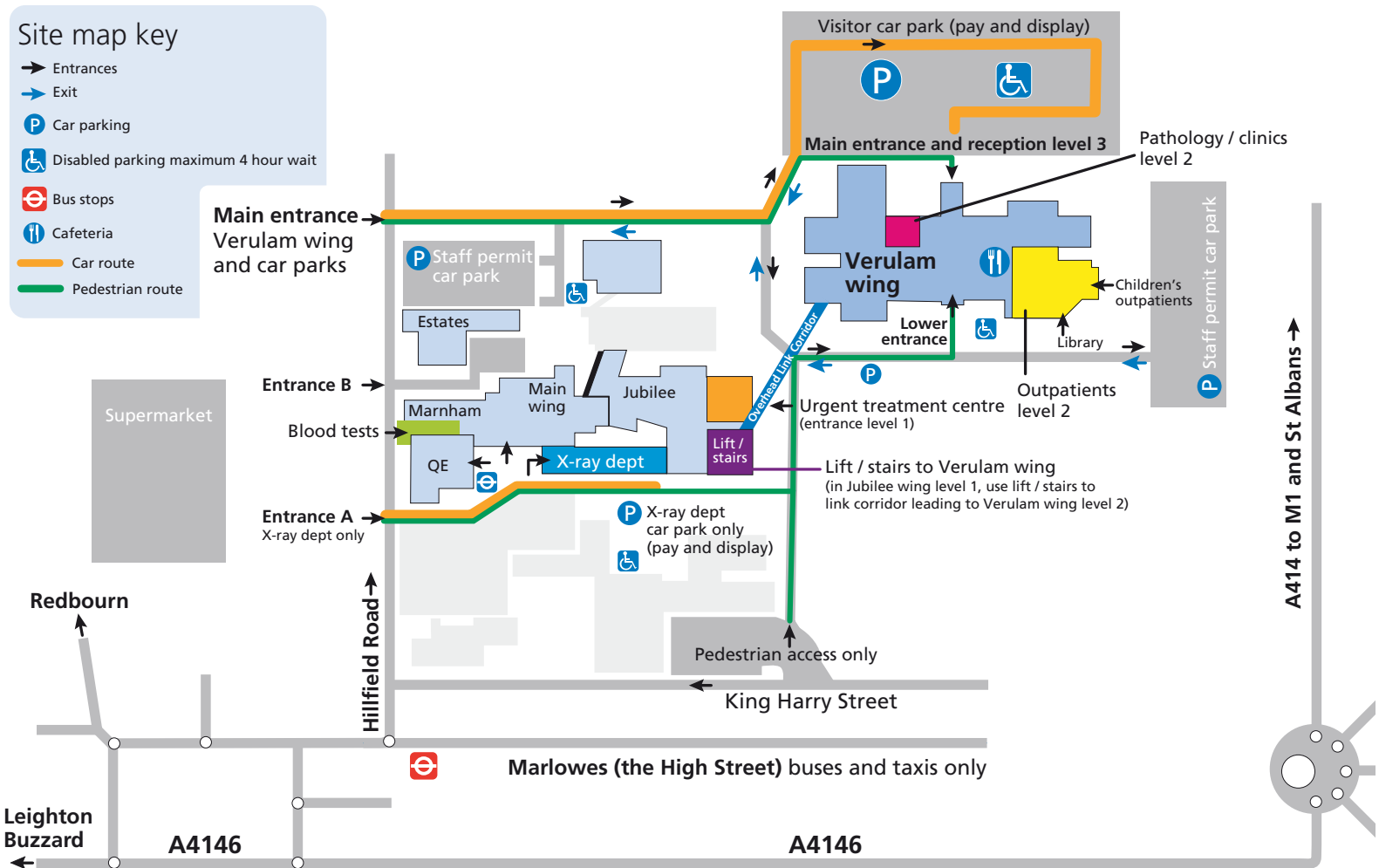

Find us online @WestHertsNHS



www.westhertshospitals.nhs.uk